

## FLAME TECH® SCRAPPER TIPS—6000, 6500 & 7500 SERIES TORCHES

### SEE THE DIFFERENCE YOURSELF WITH FLAME TECH'S FAMOUS "SCRAPPER" CUTTING TIPS

- Larger preheats reduce start time and help to "maintain the cut."
- Coarse "V" internal splines do not clog easily and can be cleaned with a pocket knife.
- Ideal for working on rusty, scaly, painted surfaces.
- Compatible with standard OEM torches.

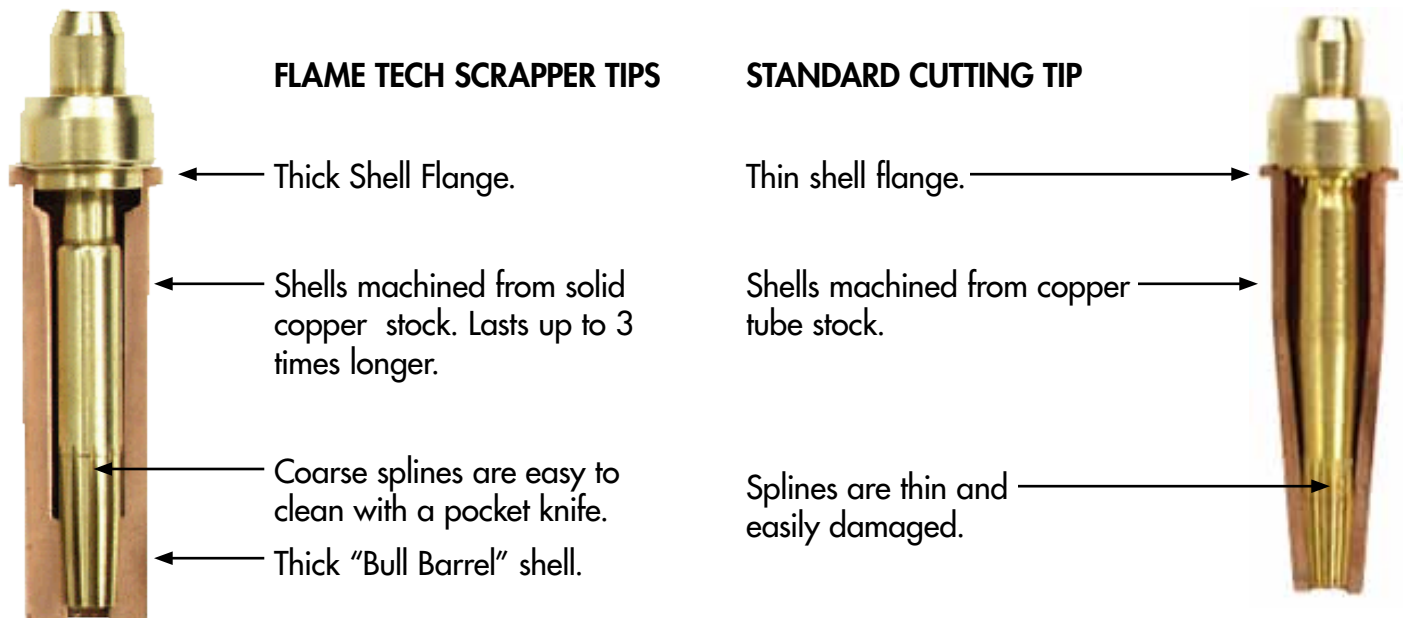

METAL THICKNESS (INCHES)	TIP SIZE		OXYGEN		FUEL GAS PSI	SPEED IPM	KERF WIDTH
	TIP NO.	DRILL SIZE	CUTTING PSI	PREHEAT PSI			
1/8	5/0	74	20-30	5-9	2-5	18-26	.035
3/16	4/0	71	30-40	5-9	2-5	18-25	.04
1/4	000	68	30-40	5-9	3-5	17-24	.05
3/8	00	64	35-45	5-10	3-5	17-23	.06
1/2	00½	62	35-45	5-10	3-6	16-22	.065
5/8	0	60	35-45	5-10	3-6	15-20	.07
3/4	0½	58	35-50	5-10	3-6	15-19	.075
1	1	56	35-50	5-10	3-6	14-18	.08
1½	1½	54	40-55	10-17	4-8	12-16	.09
2	2	52	40-55	10-17	4-8	10-14	.10
2½	2½	50	40-55	10-17	5-9	9-13	.105
3	3	48	45-60	10-17	6-10	8-11	.11
4	4	44	50-65	10-17	6-10	7-10	.13
6	5	39	60-75	10-17	8-12	5-8	.15
8	6	31	60-75	30-43	9-15	4-6	.19
9	7	28	55-65	30-43	9-15	3-5	.22
10	8	25	50-65	30-43	9-15	3-4	.24
12	10	13	45-60	30-43	10-18	2-3	.34
14	12	5	40-55	30-43	10-18	1-2	.40

## 80 SERIES BI-METAL & TRI-METAL TIP-MIX CUTTING NOZZLES



### HOSE & REGULATOR REQUIREMENTS

When cutting over 20", use 1/2" ID hose.

Oxygen supply and oxygen regulator must be capable of flows mentioned on cutting tip chart shown below.



← Brass seat for longer life and better structural integrity. Brass increases quality over copper in the drilling of the seat mixer.

← Copper barrel for better transference and dissipation of heat away from the cutting zone.

← Stainless wear ring for longer life.

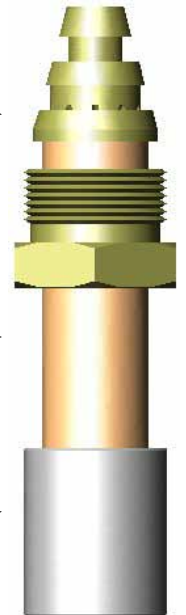

**CAUTION**  
 ALWAYS USE  
**FLASH BACK ARRESTORS**  
 (purchased separately)

80 SERIES NOZZLES				GAS PRESSURE (PSI)		GAS CONSUMPTION (CFH)	
SIZE	BI-METAL P/N	TRI-METAL P/N	METAL THICKNESS	OXYGEN	FUEL GAS	OXYGEN	FUEL GAS
12	BM80-12	TM80-12	10-12	60-100	5-15	750-1650	80-120
16	BM80-16	TM80-16	12-16	60-100	5-15	1000-1950	80-120
20	BM80-20	TM80-20	16-20	60-100	5-15	1600-2500	100-160
24	BM80-24	TM80-24	20-24	60-100	5-15	1800-3000	100-160
36	BM80-36	TM80-36	24-36	60-100	5-15	2100-3600	100-160