

8600 SERIES—CUTS UP TO 36", USES BI-METAL & TRI-METAL TIP SERIES

Check valves are recommended
—must be purchased separately.



CGA "C" Oxygen &
CGA "B" Left-hand Fuel Inlets

FEATURES

- Solid Bronze Head
- Heavy Duty Nozzle Mixing Torch
- Three Stainless Tubes in Triangular Format
- Uses Flame Tech® Designed BI-METAL or TRI-METAL 80 Series Tip-Mixing Nozzles
- Light Weight Multi-Tasking Torch

BENEFITS

- Safety First – Reduced Flashback
- Maximum Strength, Greater Rigidity
- Low Maintenance, Longer Lasting
- Ease of Operation

CAPABILITIES

Flame Tech’s 8600 Hand Cutting Torch is a heavy duty torch designed for rugged environments. This torch features a safe, tip-mix design. The 8600 series torch uses Flame Tech’s proprietary BI-METAL or TRI-METAL cutting nozzles, and is ideal for heavy cutting in scrap yards and steel mill operations. This heavy duty torch, when using the BI-METAL or TRI-METAL 80 series nozzles, can hand cut up to 36" of steel.

- Single lever actuated torch control.
- Uses CGA "C" size oxygen supply and LH CGA "B" size fuel supply to minimize the hose and regulator requirements.
- For alternative fuel only – NOT FOR ACETYLENE.

PART NUMBERING EXAMPLE

- 8648-70 = "86" indicates the torch series you are ordering
- 8648-70 = "48" indicates the length of the torch you are ordering (48" long)
- 8648-70 = "70" indicates the degree of the head (70°, 90° or 180°)

Standard lengths are 36, 48, 60, 72, 96 & 120 inches. Custom lengths available. 70°, 90° or 180° available.

» SEE PAGE 32 FOR 80 SERIES BI-METAL & TRI-METAL TIP INFORMATION



80 SERIES BI-METAL & TRI-METAL TIP-MIX CUTTING NOZZLES



HOSE & REGULATOR REQUIREMENTS

When cutting over 20", use 1/2" ID hose.

Oxygen supply and oxygen regulator must be capable of flows mentioned on cutting tip chart shown below.



← Brass seat for longer life and better structural integrity. Brass increases quality over copper in the drilling of the seat mixer.

← Copper barrel for better transference and dissipation of heat away from the cutting zone.

← Stainless wear ring for longer life.

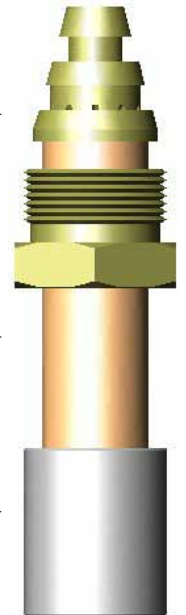

CAUTION
 ALWAYS USE
FLASH BACK ARRESTORS
 (purchased separately)

80 SERIES NOZZLES				GAS PRESSURE (PSI)		GAS CONSUMPTION (CFH)	
SIZE	BI-METAL P/N	TRI-METAL P/N	METAL THICKNESS	OXYGEN	FUEL GAS	OXYGEN	FUEL GAS
12	BM80-12	TM80-12	10-12	60-100	5-15	750-1650	80-120
16	BM80-16	TM80-16	12-16	60-100	5-15	1000-1950	80-120
20	BM80-20	TM80-20	16-20	60-100	5-15	1600-2500	100-160
24	BM80-24	TM80-24	20-24	60-100	5-15	1800-3000	100-160
36	BM80-36	TM80-36	24-36	60-100	5-15	2100-3600	100-160